



PİMTAS®

PLASTİK İNŞ. MALZ.SAN. VE TİC. A.Ş.

COMPRESSION FITTINGS PRICE LIST





*Where you are,
pintas is there...*

EXPORT TO **105** COUNTRIES

PİMTAŞ A.Ş. was founded in 1977, and it is one of the leading companies in the plastic industry that design and manufacture plastic construction materials (pipe, fittings, ball valve, butterfly valve, check valve, coupling, pool, and installation technical equipment).

Today, Pimtaş plastic has ISO 9001 Quality Management System and TSE certificate, with the latest technological infrastructure, machinery, and mold systems, exports to 105 countries -especially to European countries, and has gained the satisfaction and confidence of the consumers in 81 provinces.

Three separate production plants belonging to our company are located in Gebze Plasticizers Organized Industrial Zone and the other is located in Gebze at E5 Eskihisar turn. We have a total of 50000 m2 closed area and an open area of 22000 M2. We provide 24/7 service with more than 350 experienced employees. Since 1977, we produce and renew ourselves every year in order to provide better quality products and services to our valued customers.

Mission

To make a difference with our products and services by combining our mission-critical knowledge with technology without compromising our company is core values.

Vision

To maximize customer satisfaction by providing high standards and high-quality service with our innovative, rational, and responsible approach in parallel with the developing technology to make Pimtaş brand known all over the world.



COUPLING SYSTEM

Quick and Easy Assembly

Polypropylene fasteners combine the two main advantages of mechanical fastening systems. Push-fit and clamping: the push-fit process makes it easy to install and it is used in water applications, which are as secure as a conventional clamping fitting (mechanical balancing).



The coupling product range includes straight and reductive couplings, tees, bends, threaded connectors and end caps ranging from d20 to d110 mm and thread sizes from 1/2» to 4».

High Resistance and Corrosion Resistance

A special seal approved for drinking water, in combination with a unique body design, provides high performance in terms of suction and pressure and tensile strength and vacuum. Made of polypropylene, the housing is completely stainless and guarantees high performance as well as high resistance to pressure during long service life. The fittings are suitable for above and below ground applications due to their high resistance to UV rays.

Safe Design

Its special design provides excellent resistance to ram impact and tensile forces without having a negative impact on the life of the connection.

Implementation

The coupling system is designed for the renewal and extension of existing water lines as well as for new water line installations.

The coupling is also suitable for use as home connections and service lines. In addition, by simply unscrewing and retracting the connecting part from the pipe, the smart coupling is used for bypass systems where the temporarily laid lines need to be removed quickly and easily.

- Water Distribution Lines
- Home Connections and Service Lines
- Pressurized Waste Water
- Industrial Applications
- Mining Industry
- Golf Courses
- Camping Areas
- Farming
- Greenhouses
- High Quality Irrigation

Features

Smart coupling fittings have been developed for use in water and drinking water systems, enabling faster and easier assembly/installation compared to conventional clamping fittings.

The coated sealing system makes this product both unique and long-lasting. With its non-rusting, non-crusting properties, light weight structure, high pressure resistance, excellent cost-benefit ratio and a usage rate of at least 50 years, the smart coupling incorporates the benefits of plastics

TECHNICAL SPECIFICATIONS

PİMTAŞ couplings will be your first choice with their compliance with all important standards and wide pipe diameter range.

PİMTAŞ couplings PE 80, PE 100 and PEX-a are suitable for all types of polyethylene pipes. Coupling fittings are ready to use as they come out of the package without any preparation. The pipe can be attached directly to the coupling fittings without distributing the fittings and removing the nut. In accordance with the most stringent regulations worldwide, all coupling fittings are able to withstand an operating pressure of 16 bar.

Thanks to its international sales-logistics chain, PİMTAŞ provides the complete system of valves, fittings, pipes, measurement-control systems required by the system to the customer's service

TECHNICAL DATA

The design and installation of thermoplastic piping systems requires designers and similarly installers to consider the fact that plastics have different physical properties than metals. Although PİMTAŞ piping systems offer very robust systems, care must be taken during handling and transportation to avoid damage. Thermoplastics also have certain physical properties such as high coefficient of expansion which should be taken into consideration during the design stage.

PİMTAŞ Piping Systems, which have been successfully developing, have been providing plastic pipe systems with a high performance installation spectrum for more than 50 years, and the experience acquired has shown that plastics are a more economical and safer alternative to metals when the recommendations given in the technical literature are taken into account by engineers and installers. As a general rule for the design and installation of plastics, one of the important differences is that plastics can and should be allowed to move after commissioning, i.e. they should be able to move under temperature fluctuations and pressure changes. For example, the use of pipe clamps that allow horizontal movement and not clamping in place of the system is an obligation for plastic piping installations.

The following technical information contains the basic information necessary for an economical and trouble-free installation/assembly: However, this document does not provide all the details, for more detailed information or if you have a specific question, please contact your local PİMTAŞ Piping Systems company. You can consult us at www.pimtasplastik.com.tr or send an e-mail to pimtas@pimtasplastik.com.tr

Pressure Temperature Table

The pressure values for the thermoplastic pipe are always explained as 20° for water. It can also be used at higher temperatures, but the need to reduce the operating pressure if the operating temperature increases is a fundamental principle in thermoplastic pipe work. The table shows the maximum permissible pressures for PE pipes and PP fittings up to the maximum permissible operating temperature of + 45 °C at different temperatures. The table is based on an ambient temperature of 20 °C, where water is accepted as the medium. A safety factor with a minimum life of 50 years is included in all calculations.

Pressure-temperature table for Smart Coupling (water is taken as the medium).

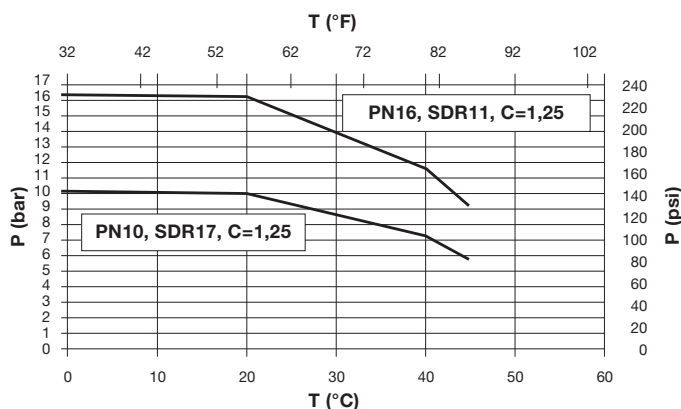

P; Permissible pressure in bar psi
T; Temperature in °C. °F

To work at temperatures below 0 °C, an antifreeze must be used to prevent freezing. The above pressure*temperature curve only applies when the medium is water, so for non-water media a ratio reduction factor should be applied to the above curve. This is a standard procedure for all plastic piping systems.

Flange Connections

Flange connections with metal joining flange

Material: Steel ST37-2 (1.0038 or S235JR)

Flange PE or PEX can be connected to a pipe without disassembly.

Dimensions;

Inch	Internal	External	Hole Circle
1 1/2	80	150	110
2	99,6	160	125
2 1/2	119	186,5	145,5
3	134,8	204,5	160
4	156,3	220	180

Please refer to our Technical Guide on Industrial applications for more information.

The Benefits

The new generation of polypropylene clamping fasteners combines the best features in both push-fit and clamping fastening technology. The coupling is the result of PIMTAŞ piping systems without compromising on continuous development and a culture based on innovation and mastery. The innovative design provides the maximum useful life for superior performance in water applications, providing the necessary advantages, such as fast, protected and effortless methods to combat waterway and weather conditions. The coupling product range includes adaptor and reducer adaptor, tees bends, threaded connectors and end caps ranging from d20 to d110 mm.



High Resistance and Corrosion Resistance

A special seal approved for drinking water, in combination with a unique body design, provides high performance in terms of suction and pressure and tensile strength and vacuum. Made of polypropylene, the housing is completely stainless and guarantees high performance as well as high resistance to pressure during long service life. The fittings are suitable for above and below ground applications due to their high resistance to UV rays.



Safe Design

Its special design provides excellent resistance to ram impact and tensile forces without having a negative impact on the life of the connection.

Technical Specifications

Smart coupling will be your first choice with compliance to all important standards and wide availability.

Coupling clamping fittings are suitable for all kinds of polyethylene PE 80, PE 100 and PEX-a pipes. As soon as the connector is removed from the box, it is ready for installation without any preparation. The complete range of coupling fittings includes a resistance of 16 bar with approvals complying with the most stringent regulations in the world. Thanks to the complete product selection of valves, fittings, pipes and control systems, Pimtaş Pipe Systems is your sole solution provider, which includes worldwide training and supply chain management.

Operating pressure range: 10 bar and 16 bar for all smart fittings for diameters from 20 to 110

Operating temperature: Between -10 and 45

Material: Body - UV Resistant Polypropylene (PP)

Nut: UV Resistant Blue Polypropylene (PP)

Clamping Part: (POM) Polyacetal.

Seal: Rubber suitable for drinking water.

Standards: **PE Pipes**
DIN EN 12201, ISO 11922-1, DIN 8074, EN 12201-1/2

Threads
DIN EN 10226(ISO 7-1),BS 21,AS1722.1

Flanges
DIN EN 1092-1,DIN 2501.1

Test standards: TS ISO 17885

Diameter 20-110



PIPE FITTING DEPTH

Fitting

Diameter	20	25	32	40	50	63
PN10	41	47,5	49	63,5	70,5	80,5
PN16	50	52	54	72	84	95

Coupling D20-110

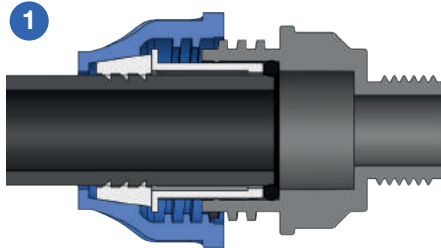

Cut the pipe straight and clean.
Mark the insertion depth on the pipe.
Table: Pipe insertion depth.
WARNING: Loosen the coupling nut but do not remove the coupling.

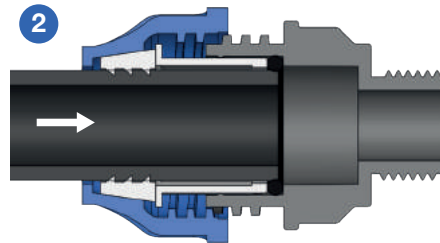

Push the pipe to the first stop (gasket) of the clamping part, (Lubricating and planing the pipe end will facilitate the process.)

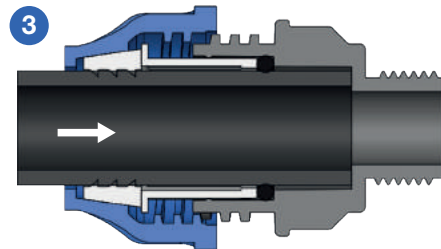

Pass the pipe through the seal and push it to the stop of the fitting. Check the insertion depth mark for correct installation.

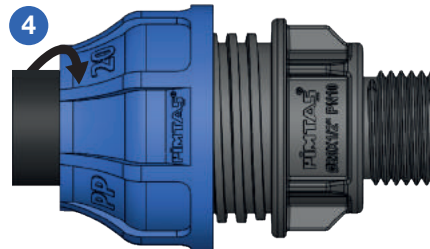

Tighten the nut until it contacts the stop ring.

20-110 mm

Check that all parts are complete before installation. (Clamping part, compression part, seal)

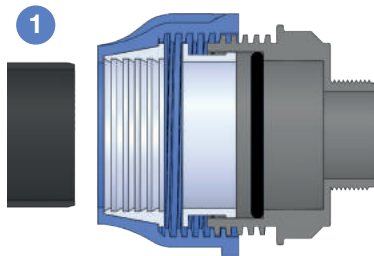

Cut the pipe straight and clean.

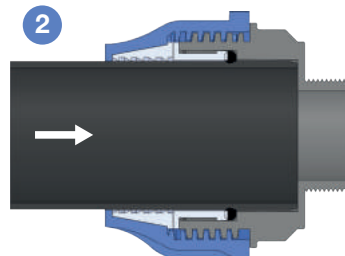

Push the pipe to the stop on the fitting.

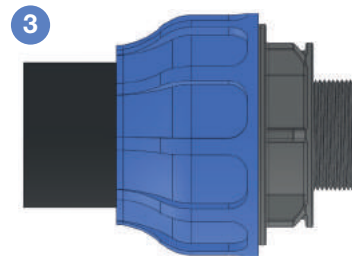

Tighten the nut to the stop ring.

REPAIR SLEEVES d 20-110

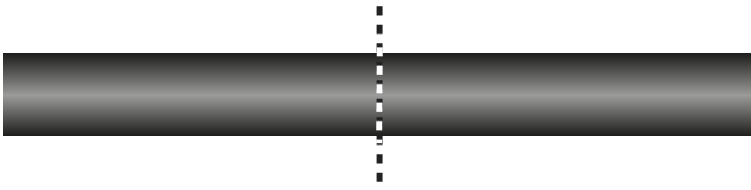

Cut the pipe perpendicular to its axis near the damaged location.

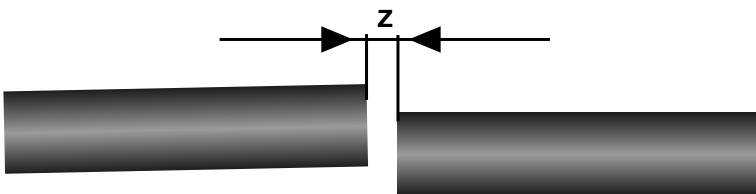

The spacing between the pipes is maintained in accordance with the pipe and fitting diameter (according to the dimensions in Table A). Pipe ends are planed approximately 15 degrees and grease is applied to the seal if necessary.

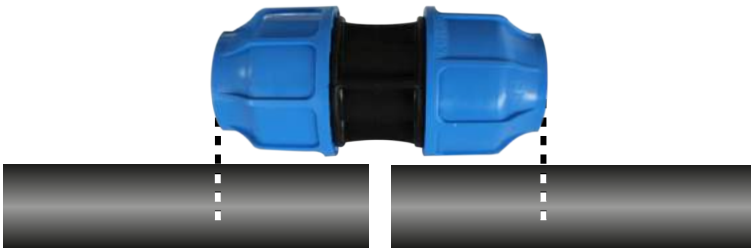

The pipes are marked as shown above.

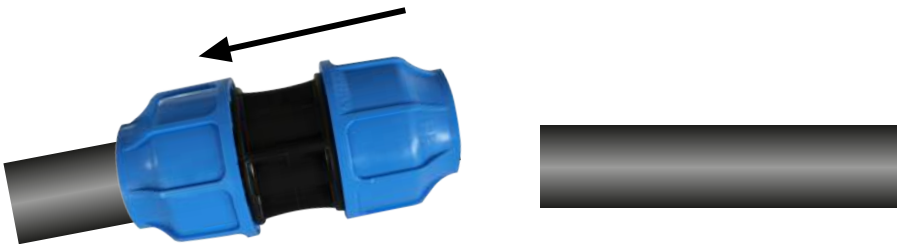

The sleeve is attached on one side of the pipe. The two pipes are aligned and the sleeve is moved to the mark on the pipe.

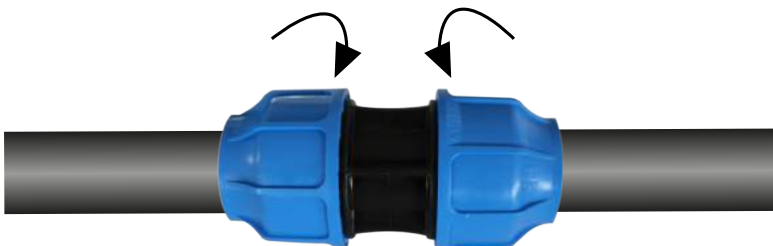

The nuts are tightened to the stop surfaces.

MALE ADAPTOR

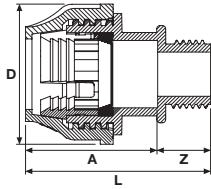

Dia	Code	D (mm)	A (mm)	Z (mm)	L (mm)	PN	Box/Pcs	Price (Pcs)
20x1/2"	EX70001100	44	48,5	14	62,5	16	800	0,21 €
20x3/4"	EX70001101	44	48,5	15	63,5	16	700	0,21 €
25x1/2"	EX70001102	50	53	14	67	16	500	0,29 €
25x3/4"	EX70001103	50	53	15	68	16	500	0,29 €
25x1"	EX70001104	50	53	17	70	16	450	0,30 €
32x1/2"	EX70001105	61	57	14	71	16	300	0,41 €
32x3/4"	EX70001106	61	57	15	72	16	300	0,41 €
32x1"	EX70001107	61	57	17	74	16	275	0,41 €
32x1 1/4"	EX70001108	61	57	20	77	16	250	0,41 €
40x1"	EX70001109	74,5	73,5	17	90,5	16	150	0,59 €
40x1 1/4"	EX70001110	74,5	73,5	20	93,5	16	150	0,59 €
40x1 1/2"	EX70001111	74,5	73,5	20	93,5	16	150	0,59 €
50x1 1/4"	EX70001112	88	84,5	20	104,5	16	90	0,98 €
50x1 1/2"	EX70001113	88	84,5	20	104,5	16	90	1,00 €
50x2"	EX70001114	88	84,5	24	108,5	16	90	1,00 €
63x1 1/2"	EX70001115	101	92,5	20	112,5	16	60	1,28 €
63x2"	EX70001116	101	92,5	24	116,5	16	54	1,54 €
63x2 1/2"	EX70001117	101	92,5	28	120,5	16	54	1,54 €
75x2"	EX70001118	124	127	24	151	16	32	2,70 €
75x2 1/2"	EX70001119	124	127	28	155	16	32	2,62 €
75x3"	EX70001120	124	127	30	157	16	32	2,70 €
90x2"	EX70001121	149	159	24	183	16	20	3,92 €
90x2 1/2"	EX70001122	149	159	28	187	16	16	4,43 €
90x3"	EX70001123	149	159	30	189	16	16	4,43 €
90x4"	EX70001124	149	159	36	195	16	16	4,90 €
110x2"	EX70001125	185	117	24	141	16	12	6,25 €
110x2 1/2"	EX70001126	185	117	28	145	16	12	7,72 €
110x3"	EX70001127	185	117	30	147	16	12	7,72 €
110x4"	EX70001128	185	117	36	153	16	12	6,90 €

COUPLING

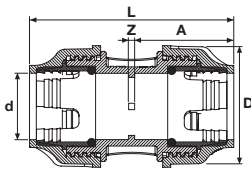

Dia	Code	D (mm)	A (mm)	Z (mm)	L (mm)	PN	Box/Pcs	Price (Pcs)
20x20	EX70001200	44	48,5	3	100	16	450	0,35 €
25x25	EX70001201	50	53	3	109	16	300	0,50 €
32x32	EX70001202	61	57	3	117	16	170	0,68 €
40x40	EX70001203	74,5	73,5	3	150	16	90	1,01 €
50x50	EX70001204	88	84,5	3	172	16	60	1,60 €
63x63	EX70001205	101	92,5	3	188	16	35	2,15 €
75x75	EX70001206	124	127	4	258	16	18	4,47 €
90x90	EX70001207	149	159	5	323	16	10	6,55 €
110x110	EX70001208	185	185	6	376	16	8	10,58 €

END CAP

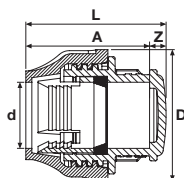

Dia	Code	D (mm)	A (mm)	Z (mm)	L (mm)	PN	Box/Pcs	Price (Pcs)
20	EX70001500	44	48,5	5,5	54	16	800	0,20 €
25	EX70001501	50	53	6,9	59,9	16	500	0,29 €
32	EX70001502	61	57	8,4	65,4	16	300	0,41 €
40	EX70001503	74,5	73,5	10	83,5	16	165	0,61 €
50	EX70001504	88	84,5	11,7	96,2	16	96	0,96 €
63	EX70001505	101	92,5	16	108,5	16	60	1,30 €
75	EX70001506	124	127	18	145	16	32	2,66 €
90	EX70001507	149	159	20	179	16	16	3,71 €
110	EX70001508	185	185	24	209	16	12	5,94 €

FEMALE ADAPTOR

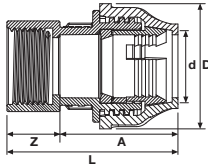

Dia	Code	D (mm)	A (mm)	Z (mm)	L (mm)	PN	Box/Pcs	Price (Pcs)
20x1/2"	EX70001000	44	48,5	14	62,5	16	700	0,23 €
20x3/4"	EX70001001	44	48,5	15	63,5	16	550	0,23 €
25x1/2"	EX70001002	50	53	14	67	16	450	0,30 €
25x3/4"	EX70001003	50	53	15	68	16	450	0,30 €
25x1"	EX70001004	50	53	17	70	16	350	0,30 €
32x1/2"	EX70001005	61	57	14	71	16	120	0,41 €
32x3/4"	EX70001006	61	57	15	72	16	275	0,41 €
32x1"	EX70001007	61	57	17	74	16	250	0,41 €
32x1 1/4"	EX70001008	61	57	20	77	16	225	0,41 €
40x1"	EX70001009	74,5	73,5	17	90,5	16	150	0,59 €
40x1 1/4"	EX70001010	74,5	73,5	20	93,5	16	150	0,59 €
40x1 1/2"	EX70001011	74,5	73,5	20	93,5	16	135	0,59 €
50x1 1/4"	EX70001012	88	84,5	20	104,5	16	90	0,99 €
50x1 1/2"	EX70001013	88	84,5	20	104,5	16	90	1,00 €
50x2"	EX70001014	88	84,5	24	108,5	16	80	1,00 €
63x1 1/2"	EX70001015	101	92,5	20	112,5	16	54	1,29 €
63x2"	EX70001016	101	92,5	24	116,5	16	54	1,54 €
63x2 1/2"	EX70001017	101	92,5	28	120,5	16	48	1,54 €
75x2"	EX70001018	124	127	24	151	16	32	2,63 €
75x2 1/2"	EX70001019	124	127	28	155	16	32	2,70 €
75x3"	EX70001020	124	127	30	157	16	28	2,70 €
90x2"	EX70001021	149	159	24	183	16	16	3,72 €
90x2 1/2"	EX70001022	149	159	28	187	16	16	4,43 €
90x3"	EX70001023	149	159	30	189	16	16	4,43 €
90x4"	EX70001024	149	159	36	195	16	12	4,43 €
110x2"	EX70001025	185	117	24	117	16	12	6,03 €
110x2 1/2"	EX70001026	185	117	28	117	16	12	6,90 €
110x3"	EX70001027	185	117	30	147	16	12	6,90 €
110x4"	EX70001028	185	117	36	153	16	12	6,90 €

REDUCING COUPLING

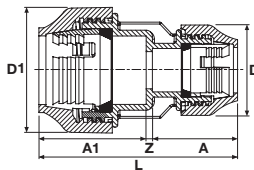

Dia	Code	D (mm)	A1 (mm)	Z (mm)	L (mm)	D1 (mm)	A (mm)	PN	Box/Pcs	Price (Pcs)
25x20	EX70001600	50	53	3	104,5	44	48,5	16	300	0,45 €
32x20	EX70001601	61	57	3	108,5	44	48,5	16	240	0,62 €
32x25	EX70001602	61	57	3	113	50	53	16	200	0,69 €
40x20	EX70001603	74,5	73,5	3	125	44	48,5	16	150	0,95 €
40x25	EX70001604	74,5	73,5	3	129,5	50	53	16	140	0,95 €
40x32	EX70001605	74,5	73,5	3	133,5	61	57	16	120	1,02 €
50x25	EX70001606	88	84,5	3	140,5	50	53	16	90	1,43 €
50x32	EX70001607	88	84,5	3	144,5	61	57	16	84	1,43 €
50x40	EX70001608	88	84,5	3	161	74,5	73,5	16	72	1,52 €
63x25	EX70001609	101	92,5	6	151,5	50	53	16	54	2,30 €
63x32	EX70001610	101	92,5	6	155,5	61	57	16	48	1,98 €
63x40	EX70001611	101	92,5	6	172	74,5	73,5	16	48	2,00 €
63x50	EX70001612	101	92,5	6	183	88	84,5	16	36	2,04 €
75x40	EX70001621	124	127	6	206,5	74,5	73,5	16	28	3,50 €
75x50	EX70001613	124	127	6	217,5	88	84,5	16	28	3,54 €
75x63	EX70001614	124	127	6	225,5	101	92,5	16	24	3,73 €
90x50	EX70001620	149	159	7	250,5	88	84,5	16	8	7,00 €
90x63	EX70001615	149	159	7	258,5	101	92,5	16	14	5,89 €
90x75	EX70001616	149	159	7	293	124	127	16	12	5,97 €
110x63	EX70001617	185	185	8	285,5	101	92,5	16	8	8,82 €
110x75	EX70001618	185	185	8	320	124	127	16	8	8,36 €
110x90	EX70001619	185	185	8	342	149	149	16	8	8,36 €

TEE

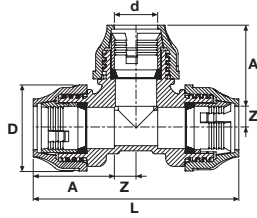

Dia	Code	D (mm)	A (mm)	Z (mm)	L (mm)	PN	Box/Pcs	Price (Pcs)
20	EX70001300	43,7	48,5	11	119	16	255	0,61 €
25	EX70001301	49,8	53	13,5	133	16	150	0,82 €
32	EX70001302	60,8	57	17	148	16	80	1,13 €
40	EX70001303	74,5	73,5	21	189	16	50	1,80 €
50	EX70001304	88	84,5	26	221	16	28	2,70 €
63	EX70001305	101	92,5	32,5	250	16	18	3,65 €
75	EX70001306	124	127	38,5	331	16	10	7,30 €
90	EX70001307	149	159	46	410	16	6	10,61 €
110	EX70001308	185	185	56	482	16	3	17,25 €

MALE TEE

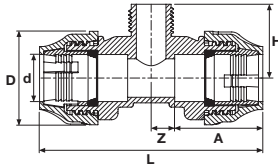

Dia	Code	D (mm)	A (mm)	Z (mm)	L (mm)	H (mm)	PN	Box/Pcs	Price (Pcs)
20x1/2"x20	EX70001900	44	48,5	11	119	34,5	16	300	0,49 €
20x3/4"x20	EX70001901	44	48,5	11	119	35,5	16	300	0,49 €
20x1"x20	EX70001929	44	48,5	11	119	39,5	16	300	0,52 €
25x1/2"x25	EX70001902	50	53	13,5	133	37,8	16	200	0,67 €
25x3/4"x25	EX70001903	50	53	13,5	133	38,8	16	200	0,67 €
25x1"x25	EX70001904	50	53	13,5	133	42,8	16	180	0,72 €
25x1 1/4"x25	EX70001905	50	53	13,5	133	44,8	16	120	0,74 €
32x1/2"x32	EX70001906	61	57	17	148	42,5	16	55	1,02 €
32x3/4"x32	EX70001907	61	57	17	148	43,5	16	120	1,02 €
32x1"x32	EX70001908	61	57	17	148	47,5	16	110	1,02 €
32x1 1/4"x32	EX70001909	61	57	17	148	49,5	16	100	1,02 €
40x1"x40	EX70001910	74,5	73,5	21	189	53,9	16	75	1,49 €
40x1 1/4"x40	EX70001911	74,5	73,5	21	189	55,9	16	60	1,49 €
40x1 1/2"x40	EX70001912	74,5	73,5	21	189	55,9	16	55	1,49 €
50x1"x50	EX70001913	88	84,5	26	221	59,9	16	44	2,35 €
50x1 1/4"x50	EX70001914	88	84,5	26	221	61,9	16	44	2,35 €
50x1 1/2"x50	EX70001915	88	84,5	26	221	61,9	16	40	2,35 €
50x2"x50	EX70001916	88	84,5	26	221	63,9	16	32	2,35 €
63x1 1/4"x63	EX70001917	101	92,5	32,5	250	69,3	16	27	3,29 €
63x1 1/2"x63	EX70001918	101	92,5	32,5	250	69,3	16	24	3,29 €
63x2"x63	EX70001919	101	92,5	32,5	250	71,3	16	21	3,29 €
63x2 1/2"x63	EX70001920	101	92,5	32,5	250	75,3	16	18	3,29 €
75x2"x75	EX70001921	124	127	38,5	331	82,5	16	16	7,67 €
75x2 1/2"x75	EX70001922	124	127	38,5	331	86,5	16	14	7,67 €
75x3"x75	EX70001923	124	127	38,5	331	88,5	16	12	7,67 €
90x2 1/2"x90	EX70001924	149	159	46	410	86,5	16	8	10,84 €
90x3"x90	EX70001925	149	159	46	410	88,5	16	8	10,84 €
90x4"x90	EX70001926	149	159	46	410	106,3	16	6	10,84 €
110x3"x110	EX70001927	185	185	56	430	100,3	16	5	17,47 €
110x4"x110	EX70001928	185	185	56	430	106,3	16	5	17,47 €

REDUCING TEE

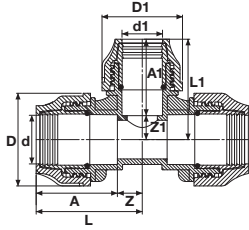

Dia	Code	D (mm)	A (mm)	Z (mm)	L (mm)	D1 (mm)	A1 (mm)	Z1 (mm)	L1 (mm)	PN	Box/Pcs	Price (Pcs)
25x20x25	EX70001700	50	53	13,5	133	44	48,5	11	119	16	180	0,81 €
32x20x32	EX70001701	61	57	17	148	44	48,5	11,0	119	16	120	1,17 €
32x25x32	EX70001702	61	57	17	148	50	53	13,5	133	16	100	1,17 €
40x25x40	EX70001703	74,5	73,5	21	189	50	53	13,5	133	16	65	1,79 €
40x32x40	EX70001704	74,5	73,5	21	189	61	57	17	148	16	55	1,79 €
50x25x50	EX70001705	88	84,5	26	221	50	53	13,5	133	16	40	2,57 €
50x32x50	EX70001706	88	84,5	26	221	61	57	17	148	16	40	2,57 €
50x40x50	EX70001707	88	84,5	26	221	74,5	73,5	21	189	16	40	2,57 €
63x25x63	EX70001708	101	92,5	32,5	250	50	53	13,5	133	16	8	3,26 €
63x32x63	EX70001709	101	92,5	32,5	250	61	57	17	148	16	24	3,26 €
63x40x63	EX70001710	101	92,5	32,5	250	74,5	73,5	21	189	16	21	3,26 €
63x50x63	EX70001711	101	92,5	32,5	250	88	84,5	26	221	16	21	3,26 €
75x50x75	EX70001712	124	127	38,5	331	88	84,5	26	221	16	14	6,48 €
75x63x75	EX70001713	124	127	38,5	331	101	92,5	32,5	250	16	12	6,76 €
90x63x90	EX70001714	149	159	46	410	101	92,5	32,5	250	16	8	9,57 €
90x75x90	EX70001715	149	159	46	410	124	127	38,5	331	16	7	9,91 €
110x63x110	EX70001716	185	185	56	482	101	92,5	32,5	250	16	6	15,77 €
110x75x110	EX70001717	185	185	56	482	124	127	38,5	331	16	2	15,66 €
110x90x110	EX70001718	185	185	56	482	149	159	46	410	16	4	15,66 €

FEMALE TEE

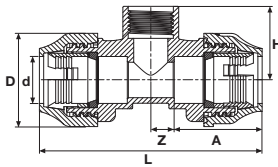

Dia	Code	D (mm)	A (mm)	Z (mm)	L (mm)	H (mm)	PN	Box/Pcs	Price (Pcs)
20x1/2"x20	EX70002300	44	48,5	11	119	34,5	16	270	0,52 €
20x3/4"x20	EX70002301	44	48,5	11	119	35,5	16	240	0,58 €
25x1/2"x25	EX70002302	50	53	13,5	133	37,8	16	200	0,71 €
25x3/4"x25	EX70002303	50	53	13,5	133	38,8	16	180	0,76 €
25x1"x25	EX70002304	50	53	13,5	133	42,8	16	160	0,79 €
32x1/2"x32	EX70002305	61	57	17	148	42,5	16	120	1,06 €
32x3/4"x32	EX70002306	61	57	17	148	43,5	16	110	1,06 €
32 x 1" x 32	EX70002307	61	57	17	148	47,5	16	100	1,07 €
40x3/4"x40	EX70002308	74,5	73,5	21	189	49,9	16	60	1,56 €
40x1"x40	EX70002309	74,5	73,5	21	189	53,9	16	60	1,56 €
40x1 1/4"x40	EX70002310	74,5	73,5	21	189	55,9	16	55	1,56 €
50x1"x50	EX70002311	88	84,5	26	221	59,9	16	40	2,31 €
50x1 1/4"x50	EX70002312	88	84,5	26	221	61,9	16	40	2,31 €
50x1 1/2"x50	EX70002313	88	84,5	26	221	61,9	16	40	2,31 €
63x1 1/4"x63	EX70002314	101	92,5	32,5	250	69,3	16	21	3,10 €
63x1 1/2"x63	EX70002315	101	92,5	32,5	250	69,3	16	21	3,10 €
63x2"x63	EX70002316	101	92,5	32,5	250	71,3	16	21	3,09 €
75x2"x75	EX70002317	124	127	38,5	331	82,5	16	14	6,44 €
75x2 1/2"x75	EX70002318	124	127	38,5	331	86,5	16	12	6,44 €
90x2 1/2"x90	EX70002319	149	159	46	410	98,3	16	8	9,01 €
90x3"x90	EX70002320	149	159	46	410	100,3	16	6	9,01 €
110x3"x110	EX70002321	185	185	56	482	112,5	16	5	14,32 €
110x4"x110	EX70002322	185	185	56	482	118,5	16	4	14,32 €

ELBOW

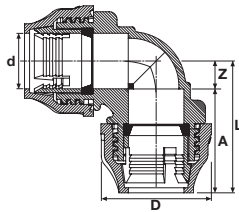

Dia	Code	D (mm)	A (mm)	Z (mm)	L (mm)	PN	Box/Pcs	Price (Pcs)
20x20	EX70001400	44	48,5	11	59,5	16	400	0,39 €
25x25	EX70001401	50	53	13,5	66,5	16	240	0,58 €
32x32	EX70001402	61	57	17	74	16	140	0,85 €
40x40	EX70001403	74,5	73,5	21	94,5	16	80	1,30 €
50x50	EX70001404	88	84,5	26	110,5	16	44	1,80 €
63x63	EX70001405	101	92,5	32,5	125	16	28	2,57 €
75x75	EX70001406	124	127	38,5	165,5	16	16	5,01 €
90x90	EX70001407	149	159	46	205	16	8	7,43 €
110x110	EX70001408	185	185	56	241	16	5	11,50 €

FEMALE ELBOW

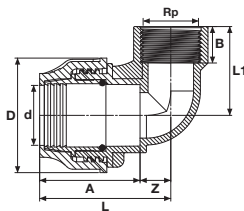

Dia	Code	D (mm)	A (mm)	Z (mm)	L (mm)	B (mm)	L1 (mm)	PN	Box/Pcs	Price (Pcs)
20x1/2"	EX70002400	44	48,5	11	59,5	14	25	16	550	0,32 €
20x3/4"	EX70002401	44	48,5	11	59,5	15	26	16	450	0,32 €
25x1/2"	EX70002402	50	53	13,5	66,5	14	27,5	16	360	0,47 €
25x3/4"	EX70002403	50	53	13,5	66,5	15	28,5	16	330	0,47 €
25x1"	EX70002404	50	53	13,5	66,5	17	30,5	16	270	0,49 €
32x3/4"	EX70002405	61	57	17	74	15	32	16	220	0,66 €
32x1"	EX70002406	61	57	17	74	17	34	16	180	0,67 €
32x1 1/4"	EX70002407	61	57	17	74	20	37	16	120	0,66 €
40x1"	EX70002408	74,5	73,5	21	94,5	17	38	16	120	0,99 €
40x1 1/4"	EX70002409	74,5	73,5	21	94,5	20	41	16	100	1,04 €
40x1 1/2"	EX70002410	74,5	73,5	21	94,5	20	41	16	90	1,19 €
50x1 1/4"	EX70002411	88	84,5	26	110,5	20	46	16	72	1,46 €
50x1 1/2"	EX70002412	88	84,5	26	110,5	20	46	16	60	1,54 €
63x1 1/2"	EX70002413	101	92,5	32,5	125	20	52,5	16	40	1,89 €
63x2"	EX70002414	101	92,5	32,5	125	24	56,5	16	40	2,07 €
75x2"	EX70002415	124	127	38,5	165,5	24	62,5	16	24	3,94 €
75x2 1/2"	EX70002416	124	127	38,5	165,5	28	66,5	16	20	3,81 €
90x2 1/2"	EX70002417	149	159	46	205	28	74	16	14	5,73 €
90x3"	EX70002418	149	159	46	205	30	76	16	13	5,98 €
110x3"	EX70002419	185	185	56	241	30	86	16	8	8,83 €
110x4"	EX70002420	185	185	56	241	36	92	16	8	9,05 €

REDUCING ELBOW

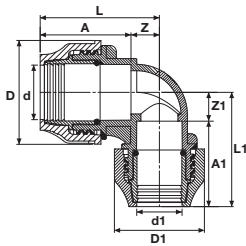

Dia	Code	D (mm)	A (mm)	Z (mm)	L (mm)	D1 (mm)	A1 (mm)	Z1 (mm)	L1 (mm)	PN	Box/Pcs	Price (Pcs)
25x20	EX70001800	50	53	13,5	66,5	44	48,5	11	59,5	16	270	0,52 €
32x25	EX70001801	61	57	17	74	50	53	13,5	66,5	16	180	0,80 €
40x32	EX70001802	74,5	73,5	21	94,5	61	57	17	74	16	90	1,31 €
50x40	EX70001803	88	84,5	26	110,5	74,5	73,5	21	94,5	16	52	1,89 €
63x50	EX70001804	101	92,5	32,5	125	88	84,5	26	110,5	16	32	2,59 €
75x63	EX70001805	124	127	38,5	165,5	101	92,5	32,5	125	16	18	4,98 €
90x75	EX70001806	149	159	46	205	124	127	38,5	165,5	16	11	7,15 €
110x90	EX70001808	185	185	56	241	149	159	46	205	16	3	10,99 €

MALE ELBOW

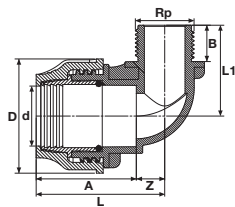

Dia	Code	D (mm)	A (mm)	Z (mm)	L (mm)	B (mm)	L1 (mm)	PN	Box/Pcs	Price (Pcs)
20x1/2"	EX70002000	44	42,5	11	53,5	14	25	16	600	0,23 €
20x3/4"	EX70002001	44	42,5	11	53,5	15	26	16	550	0,27 €
20x1"	EX70002025	44	42,5	11	53,5	17	28	16	500	0,30 €
25x1/2"	EX70002002	50	47,5	13,5	61	14	27,5	16	390	0,37 €
25x3/4"	EX70002003	50	47,5	13,5	61	15	28,5	16	390	0,37 €
25x1"	EX70002004	50	47,5	13,5	61	17	30,5	16	330	0,42 €
32x3/4"	EX70002005	61	50,5	17	67,5	15	32	16	240	0,59 €
32x1"	EX70002006	61	50,5	17	67,5	17	34	16	220	0,59 €
32x1 1/4"	EX70002007	61	50,5	17	67,5	20	37	16	200	0,65 €
40x1"	EX70002008	74,5	63	21	84	17	38	16	120	0,95 €
40x1 1/4"	EX70002009	74,5	63	21	84	20	41	16	120	0,95 €
40x1 1/2"	EX70002010	74,5	63	21	84	20	41	16	110	1,11 €
50x1 1/4"	EX70002011	88	70,5	26	96,5	20	46	16	72	1,43 €
50x1 1/2"	EX70002012	88	70,5	26	96,5	20	46	16	72	1,43 €
50x2"	EX70002013	88	70,5	26	96,5	24	50	16	64	1,45 €
63x1 1/2"	EX70002014	101	80,5	32,5	113	20	52,5	16	44	1,95 €
63x2"	EX70002015	101	80,5	32,5	113	24	56,5	16	40	1,91 €
63x2 1/2"	EX70002016	101	80,5	32,5	144,5	28	60,5	16	36	2,27 €
75x2"	EX70002017	124	112	38,5	150,5	24	62,5	16	24	3,45 €
75x2 1/2"	EX70002018	124	112	38,5	150,5	28	66,5	16	24	3,71 €
75x3"	EX70002019	124	112	38,5	180,5	30	68,5	16	20	4,44 €
90x2 1/2"	EX70002020	149	142	46	188	28	74	16	14	5,41 €
90x3"	EX70002021	149	142	46	188	30	76	16	14	5,81 €
90x4"	EX70002022	149	142	46	219	36	82	16	12	5,91 €
110x2 1/2"	EX70002026	185	173	56	229	28	84	16	8	8,65 €
110x3"	EX70002023	185	173	56	229	30	86	16	8	8,71 €
110x4"	EX70002024	185	173	56	229	36	92	16	8	8,71 €

U-PVC SINGLE UNION BALL VALVE BOTH SIDES COMPRESSION OUTLET

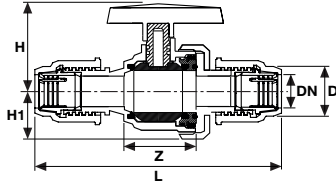

Dia	Code	DN (mm)	Z (mm)	L (mm)	H (mm)	H1 (mm)	Basınc PN	Box/Pcs	Price (Pcs)
20	233 300 20 2	15	52	129	47	27	16	55	☎
25	233 300 25 2	20	58	140	51	31	16	30	☎
32	233 300 32 2	25	61	150	63	33	16	60	☎
40	233 300 40 2	32	73	175	67	42	16	30	☎
50	233 300 50 2	40	82	200	86	46	16	24	☎
63	233 300 63 2	50	95	224	101	58	16	12	☎
75	233 300 75 2	65	118	255	110	64	16	9	☎
90	233 300 90 2	80	139	292	137	90	16	4	☎
110	233 30 110 2	100	165	340	150	106	16	2	☎

U-PVC ONE SIDE FEMALE THREADED ONE SIDE COMPRESSION OUTLET SINGLE UNION BALL VALVE

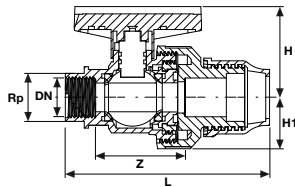

Dia	Rp (Inch)	Code	DN (mm)	Z (mm)	L (mm)	H (mm)	H1 (mm)	PN	Box/Pcs	Price (Pcs)
20	1/2"	233 100 20 2	15	52	104	47	27	16	55	☎
25	3/4"	233 100 25 2	20	58	108	51	31	16	30	☎
32	1"	233 100 32 2	25	61	120	63	33	16	60	☎
40	1 1/4"	233 100 40 2	32	73	158	67	42	16	30	☎
50	1 1/2"	233 100 50 2	40	82	175	86	46	16	24	☎
63	2"	233 100 63 2	50	95	190	101	58	16	12	☎
75	2 1/2"	233 100 75 2	65	118	225	110	64	16	9	☎
90	3"	233 100 90 2	80	139	260	137	90	16	4	☎
110	4"	233 10 110 2	100	165	305	150	106	16	2	☎

U-PVC ONE SIDE MALE THREADED ONE SIDE COMPRESSION OUTLET SINGLE UNION BALL VALVE

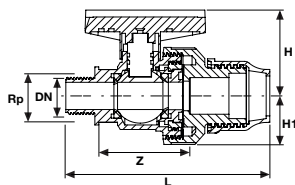

Dia	Rp (Inch)	Code	DN (mm)	Z (mm)	L (mm)	H (mm)	H1 (mm)	PN	Box/Pcs	Price (Pcs)
20	1/2"	233 200 20 2	15	52	116	47	27	16	55	☎
25	3/4"	233 200 25 2	20	58	125	51	31	16	30	☎
32	1"	233 200 32 2	25	61	135	63	33	16	60	☎
40	1 1/4"	233 200 40 2	32	73	160	67	42	16	30	☎
50	1 1/2"	233 200 50 2	40	82	185	86	46	16	24	☎
63	2"	233 200 63 2	50	95	210	101	58	16	12	☎
75	2 1/2"	233 200 75 2	65	118	230	110	64	16	9	☎
90	3"	233 200 90 2	80	139	270	137	90	16	4	☎
110	4"	233 20 110 2	100	165	305	150	106	16	2	☎

U-PVC SOLVENT CEMENT SINGLE UNION BALL VALVE ONE SIDE FLANGED

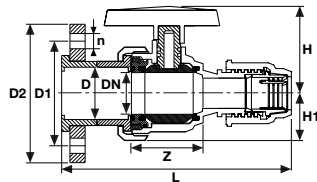

Dia	Code	DN (mm)	Z (mm)	L (mm)	H (mm)	H1 (mm)	D1 (mm)	D2 (mm)	n (mm)	PN	Box/Pcs	Price (Pcs)
20	233 017 020 2	15	52	133	47	27	65	96	14x4	16	64	☎
25	233 017 025 2	20	58	150	51	31	75	105	14x4	16	56	☎
32	233 017 032 2	25	61	169	63	33	85	115	14x4	16	36	☎
40	233 017 040 2	32	73	195	67	42	100	140	14x4	16	30	☎
50	233 017 050 2	40	82	228	86	46	100	150	18x4	16	20	☎
63	233 017 063 2	50	95	251	101	58	125	165	18x4	16	20	☎
75	233 017 075 2	65	118	292	110	64	145	185	22x4	16	8	☎
90	233 017 090 2	80	139	356	137	90	160	200	22x8	16	4	☎
110	233 017 110 2	100	165	425	150	106	180	220	24x8	16	2	☎

U-PVC COMPRESSION OUTLET SPRING CHECKVALVE

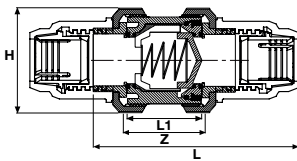

Dia	Code	DN (mm)	Z (mm)	L (mm)	H (mm)	PN	Box/Pcs	Price (Pcs)
20	214 01 020 2	16	52	150	54	16	60	☎
25	214 01 025 2	20	58	165	62	16	75	☎
32	214 01 032 2	25	61	182	66	16	60	☎
40	214 01 040 2	32	73	205	84	16	32	☎
50	214 01 050 2	40	82	240	92	16	20	☎
63	214 01 063 2	50	95	275	116	16	13	☎
75	214 01 075 2	65	118	310	146	16	9	☎
90	214 01 090 2	80	139	360	178	16	4	☎
110	214 01 110 2	100	165	420	210	16	2	☎

U-PVC ONE SIDE FEMALE THREADED ONE SIDE COMPRESSION OUTLET SPRING CHECKVALVE

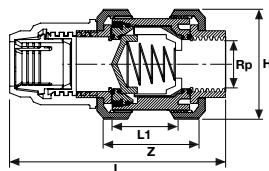

Dia	Rp Inch	Code	DN (mm)	Z (mm)	L (mm)	H (mm)	PN	Box/Pcs	Price (Pcs)
20	1/2"	215 01 020 2	16	52	104	54	16	60	☎
25	3/4"	215 01 025 2	20	58	108	62	16	75	☎
32	1"	215 01 032 2	25	61	120	66	16	60	☎
40	1 1/4"	215 01 040 2	32	73	158	84	16	32	☎
50	1 1/2"	215 01 050 2	40	82	175	92	16	20	☎
63	2"	215 01 063 2	50	95	190	116	16	13	☎
75	2 1/2"	215 01 075 2	65	118	225	146	16	9	☎
90	3"	215 01 090 2	80	139	260	178	16	4	☎
110	4"	215 01 110 2	100	165	305	210	16	2	☎

PP CLAMP SADDLE (4 BOLTS)

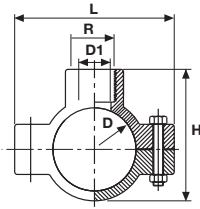

D (mm)	R (mm)	Code	d1 (mm)	L (mm)	H (mm)	PN	Box/Pcs	Price (Pcs)
25	1/2"	EX529 01 25020 2	16	54	52	16	325	0,48 €
32	1/2"	EX529 01 32020 2	16	78	62	16	275	0,51 €
32	3/4"	EX529 01 32025 2	21	78	62	16	275	0,51 €
32	1"	EX529 01 32032 2	27	78	62	16	125	0,61 €
40	1/2"	EX529 01 40020 2	16	80	68	16	200	0,56 €
40	3/4"	EX529 01 40025 2	21	80	68	16	200	0,56 €
40	1"	EX529 01 40032 2	27	80	68	16	80	0,56 €
50	1/2"	EX529 01 50020 2	16	84	81	16	160	0,75 €
50	3/4"	EX529 01 50025 2	21	84	81	16	160	0,75 €
50	1"	EX529 01 50032 2	27	84	81	16	150	0,75 €
50	1 1/4"	EX529 01 50040 2	35	84	81	16	40	1,04 €
50	1 1/2"	EX529 01 50050 2	42	98	93	16	30	1,04 €
63	1/2"	EX529 01 63020 2	16	98	93	16	100	1,10 €
63	3/4"	EX529 01 63025 2	21	98	93	16	100	1,10 €
63	1"	EX529 01 63032 2	27	98	93	16	100	1,10 €
63	1 1/4"	EX529 01 63040 2	35	98	93	16	70	1,47 €
63	1 1/2"	EX529 01 63050 2	42	98	93	16	45	1,47 €
75	1/2"	EX529 01 75020 2	16	117	102	16	80	1,28 €
75	3/4"	EX529 01 75025 2	21	117	104	16	80	1,28 €
75	1"	EX529 01 75032 2	27	117	107	16	80	1,28 €
75	1 1/4"	EX529 01 75040 2	35	117	109	16	50	1,45 €
75	1 1/2"	EX529 01 75050 2	42	117	109	16	50	1,45 €
75	2"	EX529 01 75063 2	53	117	111	16	45	1,35 €
90	1/2"	EX529 01 90020 2	16	128	116	16	60	1,53 €
90	3/4"	EX529 01 90025 2	21	128	118	16	60	1,53 €
90	1"	EX529 01 90032 2	27	128	121	16	60	1,53 €
90	1 1/4"	EX529 01 90040 2	35	128	123	16	50	1,58 €
90	1 1/2"	EX529 01 90050 2	42	128	123	16	50	1,59 €
90	2"	EX529 01 90063 2	53	128	126	16	45	1,60 €
110	1/2"	EX529 01 11020 2	15	146	150	16	50	1,65 €
110	3/4"	EX529 01 11025 2	20	146	150	16	50	1,66 €
110	1"	EX529 01 11032 2	26	146	150	16	45	1,69 €
110	1 1/4"	EX529 01 11040 2	35	146	150	16	40	1,69 €
110	1 1/2"	EX529 01 11050 2	41	146	150	16	40	1,94 €
110	2"	EX529 01 11063 2	51	146	150	16	30	1,94 €
125	1/2"	EX529 01 12520 2	15	166	169	16	10	2,47 €
125	3/4"	EX529 01 12525 2	20	166	169	16	44	2,47 €
125	1"	EX529 01 12532 2	26	166	169	16	44	2,47 €
125	1 1/4"	EX529 01 12540 2	35	166	169	16	40	2,61 €
125	1 1/2"	EX529 01 12550 2	41	166	169	16	40	2,61 €
125	2"	EX529 01 12563 2	50	166	169	16	40	2,61 €
140	1/2"	EX529 01 14020 2	18	178	191	16	6	3,50 €
140	3/4"	EX529 01 14025 2	24	178	191	16	20	3,50 €
140	1"	EX529 01 14032 2	30	178	191	16	20	3,53 €
140	1 1/4"	EX529 01 14040 2	38	178	191	16	20	3,67 €
140	1 1/2"	EX529 01 14050 2	45	178	191	16	20	3,70 €
140	2"	EX529 01 14063 2	50	178	191	16	20	3,71 €
160	1/2"	EX529 01 16020 2	18	216	215	16	6	4,49 €
160	3/4"	EX529 01 16025 2	24	216	215	16	16	4,48 €
160	1"	EX529 01 16032 2	30	216	215	16	50	4,50 €
160	1 1/4"	EX529 01 16040 2	38	216	215	16	16	4,60 €
160	1 1/2"	EX529 01 16050 2	45	216	215	16	16	4,60 €
160	2"	EX529 01 16063 2	50	216	215	16	16	4,60 €
200	1 1/2"	EX529 01 20050 2	45	262	245	16	10	6,86 €
200	2"	EX529 01 20063 2	50	262	245	16	10	6,86 €

PP BOTH SIDE SOCKETED CLAMP SADDLE WITH SCREWS

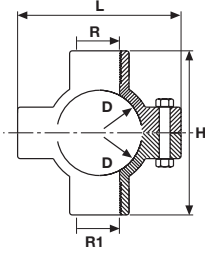

D (mm)	R (mm)	R1 (mm)	Code	L (mm)	H (mm)	PN	Box/Pcs	Price (Pcs)
32	1/2"	1/2"	EX529 11 03202020 2	54	52	16	300	0,72 €
32	3/4"	3/4"	EX529 11 03202525 2	54	82	16	200	0,72 €
32	1"	1"	EX529 11 03203232 2	78	82	16	125	0,72 €
40	1/2"	1/2"	EX529 11 04002020 2	78	82	16	175	0,78 €
40	3/4"	3/4"	EX529 11 04002525 2	80	88	16	150	0,78 €
40	1"	1"	EX529 11 04003232 2	80	88	16	80	0,78 €
50	1/2"	1/2"	EX529 11 05002020 2	80	88	16	140	0,93 €
50	3/4"	3/4"	EX529 11 05002525 2	84	101	16	120	0,93 €
50	1"	1"	EX529 11 05003232 2	84	101	16	110	0,93 €
50	1 1/4"	1 1/4"	EX529 11 05004040 2	84	101	16	30	1,14 €
50	1 1/2"	1 1/2"	EX529 11 05005050 2	98	114	16	30	1,14 €
63	1/2"	1/2"	EX529 11 06302020 2	98	114	16	80	1,42 €
63	3/4"	3/4"	EX529 11 06302525 2	98	114	16	70	1,42 €
63	1"	1"	EX529 11 06303232 2	98	114	16	70	1,42 €
63	1 1/4"	1 1/4"	EX529 11 06304040 2	98	114	16	50	1,77 €
63	1 1/2"	1 1/2"	EX529 11 06305050 2	117	117	16	50	1,77 €
75	1/2"	1/2"	EX529 11 07502020 2	117	118	16	60	1,73 €
75	3/4"	3/4"	EX529 11 07502525 2	117	129	16	60	1,73 €
75	1"	1"	EX529 11 07503232 2	117	129	16	60	1,73 €
75	1 1/4"	1 1/4"	EX529 11 07504040 2	117	129	16	40	2,00 €
75	1 1/2"	1 1/2"	EX529 11 07505050 2	117	129	16	40	2,00 €
75	2"	2"	EX529 11 07506363 2	117	111	16	30	2,08 €
90	1/2"	1/2"	EX529 11 09002020 2	128	131	16	55	1,78 €
90	3/4"	1/2"	EX529 11 09002525 2	128	134	16	55	1,78 €
90	1"	1"	EX529 11 09003232 2	128	141	16	55	1,78 €
90	1 1/4"	1 1/4"	EX529 11 09004040 2	128	143	16	40	2,22 €
90	1 1/2"	1 1/2"	EX529 11 09005050 2	128	143	16	35	2,22 €
90	2"	2"	EX529 11 09006363 2	128	146	16	30	2,22 €
110	1/2"	1/2"	EX529 11 11002020 2	146	173	16	50	2,15 €
110	3/4"	3/4"	EX529 11 11002525 2	146	173	16	50	2,15 €
110	1"	1"	EX529 11 11003232 2	146	173	16	50	2,15 €
110	1 1/4"	1 1/4"	EX529 11 11004040 2	146	173	16	35	2,56 €
110	1 1/2"	1 1/2"	EX529 11 11005050 2	146	173	16	35	2,56 €
110	2"	2"	EX529 11 11006363 2	146	173	16	30	2,56 €
125	1/2"	1/2"	EX529 11 12502020 2	166	193	16	10	5,05 €
125	3/4"	3/4"	EX529 11 12502525 2	166	193	16	10	5,05 €
125	1"	1"	EX529 11 12503232 2	166	193	16	36	5,05 €
125	1 1/4"	1 1/4"	EX529 11 12504040 2	166	193	16	32	5,05 €
125	1 1/2"	1 1/2"	EX529 11 12505050 2	166	193	16	32	5,05 €
125	2"	2"	EX529 11 12506363 2	166	193	16	32	5,05 €
140	1/2"	1/2"	EX529 11 14002020 2	178	216	16	6	7,08 €
140	3/4"	3/4"	EX529 11 14002525 2	178	216	16	24	7,08 €
140	1"	1"	EX529 11 14003232 2	178	216	16	24	7,08 €
140	1 1/4"	1 1/4"	EX529 11 14004040 2	178	216	16	24	7,08 €
140	1 1/2"	1 1/2"	EX529 11 14005050 2	178	216	16	24	7,08 €
140	2"	2"	EX529 11 14006363 2	178	216	16	22	7,08 €
160	1/2"	1/2"	EX529 11 16002020 2	216	230	16	6	8,09 €
160	3/4"	3/4"	EX529 11 16002525 2	216	230	16	16	8,09 €
160	1"	1"	EX529 11 16003232 2	216	230	16	16	8,09 €
160	1 1/4"	1 1/4"	EX529 11 16004040 2	216	230	16	14	8,09 €
160	1 1/2"	1 1/2"	EX529 11 16005050 2	216	230	16	14	8,09 €
160	2"	2"	EX529 11 16006363 2	216	230	16	14	8,09 €
200	1 1/2"	1 1/2"	EX529 11 20005050 2	262	230	16	8	14,44 €
200	2"	2"	EX529 11 20006363 2	262	230	16	8	14,44 €

ADAPTER KEY



Dia	Code	Sack/Pcs	Price (Pcs)
25x32	70003000	700	1,39 €
40x50x63x75	70003001	230	3,90 €
90x110	70003002	50	4,94 €

VALVE BOX



Dia	Code	Pallet/Pcs	Price (Pcs)
6"	70003400	600	3,41 €

VALVE BOX



Dia	Code	Pallet/Pcs	Price (Pcs)
10"	70003401	300	6,58 €

VALVE BOX (STANDARD)



Dia	Code	Pallet/Pcs	Price (Pcs)
12"	70003500	168	8,80 €

VALVE BOX (JUMBO)



Dia	Code	Pallet/Pcs	Price (Pcs)
14"	70003501	116	14,44 €

VALVE BOX (MAXI JUMBO)



Dia	Code	Pallet/Pcs	Price (Pcs)
16"	70003502	100	49,53 €

AIR SUCTION VALVE (VACUUM)



Dia	Code	Box/Pcs	Price (Pcs)
1" One Step	729 02 032 2	30	41,07 €
2" One Step	729 02 063 2	14	74,80 €
1" Double Steps	729 12 032 2	30	41,07 €
2" Double Steps	729 12 063 2	14	74,80 €

AIR RELIFF COCK



Code	Box/Pcs	Price (Pcs)
729 02 00 00	1	4,00 €

MONOMETER



Dia	Code	Box/Pcs	Price (Pcs)
3 bar	729 02 000 3	30	18,67 €
10 bar	729 02 001 0	14	24,00 €

FLAX FIBER (FIRST QUALITY)



Code	Sack/Kg	Price (Sack)
70006606	25	338,62 €
70006603	50	677,25 €

TEFLON TAPE



Dia	Code	Box/Pcs	Price (Pcs)
12x10	70006800	1000	0,41 €
12x20	70006801	1000	0,60 €
19x50	70006802	250	1,41 €

SPARE PARTS FOR COMPRESSION FITTINGS

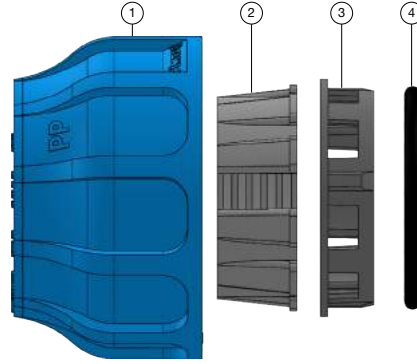

1. NUT

Çap	Kod	Poşet/Adet	Fiyat (Adet)
20	232300202	100	₺
25	232300252	100	₺
32	232300322	100	₺
40	232300402	50	₺
50	232300502	50	₺
63	232300632	30	₺
75	232300752	20	₺
90	232300902	10	₺
110	232301102	10	₺

2. LOCKING RING

Çap	Kod	Poşet/Adet	Fiyat (Adet)
20	232110202	100	₺
25	232110252	100	₺
32	232110322	100	₺
40	232110402	50	₺
50	232110502	50	₺
63	232110632	30	₺
75	232110632	20	₺
90	232110902	10	₺
110	232111102	10	₺

3. O-RING HOLDER

Çap	Kod	Poşet/Adet	Fiyat (Adet)
20	70100020	100	₺
25	70100025	100	₺
32	70100032	100	₺
40	70100040	50	₺
50	70100050	50	₺
63	70100063	30	₺
75	70100075	20	₺
90	70100090	10	₺
110	70100110	10	₺

4. O-RING

Çap	Kod	Poşet/Adet	Fiyat (Adet)
20	70000209	100	₺
25	70000259	100	₺
32	70000329	100	₺
40	70000409	100	₺
50	70000509	100	₺
63	70000639	100	₺
75	70000759	50	₺
90	70000909	50	₺
110	700001109	50	₺

SPARE PARTS FOR PP CLAMP SADDLE

1. BODY OF CLAMP SADDLE (UPPER PART)

D	R	Kod	Poşet/Adet	Fiyat (Adet)
25	1/2"	52931250202	20	☎
32	1/2"	52931320202	20	☎
32	3/4"	52931320252	20	☎
32	1"	52931320322	20	☎
40	1/2"	52931400202	20	☎
40	3/4"	52931400252	20	☎
40	1"	52931400322	20	☎
50	1/2"	52931500202	20	☎
50	3/4"	52931500252	20	☎
50	1"	52931500322	20	☎
50	1 1/4"	52931500402	20	☎
50	1 1/2"	52931500502	20	☎
63	1/2"	52931630202	20	☎
63	3/4"	52931630252	20	☎
63	1"	52931630322	20	☎
63	1 1/4"	52931630402	20	☎
63	1 1/2"	52931630502	20	☎
75	1/2"	52931750202	20	☎
75	3/4"	52931750252	20	☎
75	1"	52931750322	20	☎
75	1 1/4"	52931750402	20	☎
75	1 1/2"	52931750502	20	☎
75	2"	52931750632	20	☎
90	1/2"	52931900202	20	☎
90	3/4"	52931900252	20	☎
90	1"	52931900322	20	☎
90	1 1/4"	52931900402	20	☎
90	1 1/2"	52931900502	20	☎
90	2"	52931900632	20	☎
110	1/2"	52931110202	20	☎
110	3/4"	52931110252	20	☎
110	1"	52931110322	20	☎
110	1 1/4"	52931110402	20	☎
110	1 1/2"	52931110502	20	☎
110	2"	52931110632	20	☎
125	1/2"	52931125202	20	☎
125	3/4"	52931125252	20	☎
125	1"	52931125322	20	☎
125	1 1/4"	52931125402	20	☎
125	1 1/2"	52931125502	20	☎
125	2"	52931125632	20	☎
140	1/2"	52931140202	20	☎
140	3/4"	52931140252	20	☎
140	1"	52931140322	20	☎
140	1 1/4"	52931140402	20	☎
140	1 1/2"	52931140502	20	☎
140	2"	52931140632	20	☎
160	1/2"	52931160202	20	☎
160	3/4"	52931160252	20	☎
160	1"	52931160322	20	☎
160	1 1/4"	52931160402	20	☎
160	1 1/2"	52931160502	20	☎
160	2"	52931160632	20	☎
200	1 1/2"	52931200502	20	☎
200	2"	52931200632	20	☎

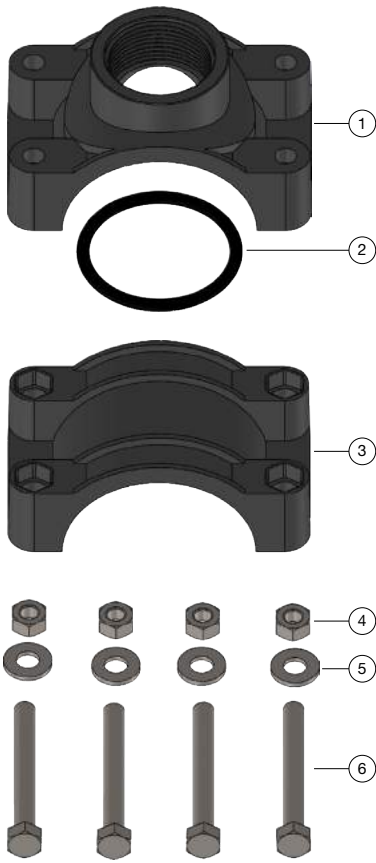

2. O-RING FOR CLAMP SADDLE

Çap	Kod	Poşet/Adet	Fiyat (Adet)
25	202100509	100	☎
32	202030259	100	☎
40	202030259	100	☎
50	221050508	100	☎
63	202030509	100	☎
75-90	221011057	50	☎
110-125-140	221011062	50	☎
160-200	221014065	50	☎

3. BODY OF CLAMP SADDLE (UNDER PART)

Çap	Kod	Poşet/Adet	Fiyat (Adet)
25	52921250202	20	☎
32	52921320252	20	☎
40	52921400202	20	☎
50	52921500202	20	☎
63	52921630202	20	☎
75	52921750202	20	☎
90	52921900202	20	☎
110	52921110202	20	☎
125	52921125202	20	☎
140	52921140202	20	☎
160	52921160202	20	☎
200	52921200202	20	☎

4. NUT

Çap	Kod	Poşet/Adet	Fiyat (Adet)
25-32-40-50	5290264014	100	☎
63-75-90-110	529010034	100	☎
125-140-160	529010034	100	☎
200	201151910	100	☎

5. REINFORCING RING

Çap	Kod	Poşet/Adet	Fiyat (Adet)
25-32-40-50	5290364014	100	☎
63-75-90-110	529010024	100	☎
125-140-160	529010024	100	☎
200	100304500	100	☎

6. BOLT

Çap	Kod	Poşet/Adet	Fiyat (Adet)
25-32-40-50	5290164014	100	☎
63	529010014	100	☎
75	529010017	100	☎
90-110	529010018	100	☎
125-140	529010019	100	☎
160-200	529010010	100	☎



PİMTAS®

PLASTİK İNŞ. MALZ.SAN. VE TİC. A.Ş.

Gebze Plastikçiler Organize San. Böl. Cumhuriyet Cad. No:52 Gebze/ KOCAELİ

T: +90 262 751 24 24 / F:+90 262 751 42 04

pimtas@pimtasplastik.com.tr